

PITTSFORD REGATTA

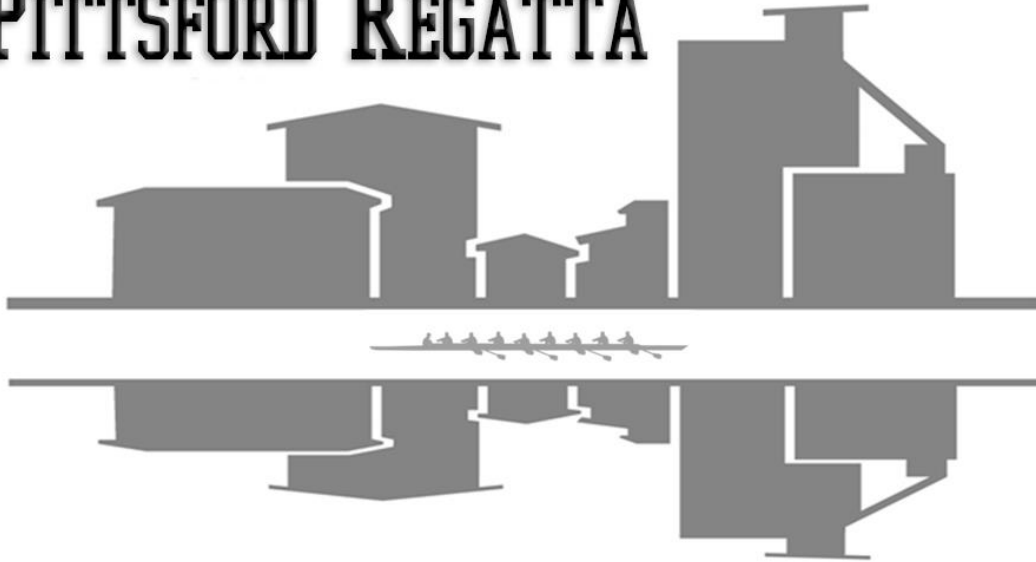

May 28 & May 29, 2022
Pittsford, NY

Welcome to Pittsford Crew's Pittsford Regatta. Beginning in 1997 as an exhibition row for the newly formed Pittsford Crew, a high school club, the Pittsford Regatta has grown to the two day event it is today. Featuring Master rowing on Saturday morning and High school sweep rowing Saturday afternoon and Sunday, the Regatta takes place in the beautiful Village of Pittsford, on the Erie Canal. The first day of the 2022 Pittsford Regatta will coincide with the annual Pittsford Paddle & Pour Festival, featuring craft beer and wine tasting, live music all day and an artisan marketplace, adjacent to the Erie Canal near the race finish line (paddleandpour.org).

Masters events will have a 1200 meter straight head style course starting just east of the Mitchell Road Bridge. High School events will race on the same 1200 meter course running in two lanes beginning just east of the Mitchell Road Bridge. Maps can be found in this document.

Masters events are Head Race style. High School races are two lane time trials followed by Sprint Races for semis and finals. Saturday the HS Girls fours and Boys eights will compete and Sunday the Boys fours and Girls eights will be on the water.

All races will finish in the center of Pittsford Village along Schoen Place allowing excellent viewing of the finish line. Also, the entire course is visible from the towpath that follows the canal. A word of caution: *rules prohibiting coaching from shore will be strictly enforced by the USRA race officials.*

Registration:

All registrations are via <http://www.RegattaCentral.com>

Waivers:

This is a USRowing Registered Regatta. All participants must sign an on-line waiver or need to supply signed copy of the U S Rowing waiver.

Eligibility:

Novices: Any rower that has not participated in a sweep oar event in an on-the-water regatta before July 1, 2021.

High School events:

The fastest boat in any category from a team must be registered as an 'A' boat and registered in the 'A' boat race. Second (B) and third (C) entries will be registered in the 'B' races. Separate medals will be awarded for the 'A' and 'B' races provided there are at least three boats in the race. Any boat registered in a 'B' race without a boat in the 'A' race will have that registration moved by the organizing committee to the 'A' race.

The venue has two race lanes; therefore we will have heats or time trials as needed, semi's and finals.

If there are:

1 Boat Registered

No Race

2 Boats

Finals only

3 or more Boats

Time Trial, Semi and Finals

Launching Location & Parking:

The trailer parking and boat launching are at the Village of Pittsford Department of Public Works 1 Village lane. Directions are available on our web site at: [Pittsford Regatta Web Page](http://www.pittsfordcrew.org/pittsford-regatta.html) (<http://www.pittsfordcrew.org/pittsford-regatta.html>)

Trailers/Car toppers:

There will be parking for trailers on Village Lane. Parking for cars will be in the adjacent parking lots and in the village for spectators. Car top carriers will be allowed to park for the time needed to unload adjacent to the launch area. They are then asked to move their cars so others can do the same.

Hospitality:

Space is limited, so unloading will be allowed but cars can not stay in the launch area.

Spectator Parking and viewing Location

Hospitality:

Hospitality tent space will be on in the launching area on the grass adjacent to the canal tow path. This is immediately adjacent to the launch area, the finish line is an easy 5 minute walk along the tow path eastward toward the village.

Free public parking is available in the village at various locations within a 3 minute walk of the venue. Parking is also available near the launch site.

Practice:

The docks will be installed and ready on late Friday morning. **For 2022, we are not allowing teams to go out onto the course to practice, as several setup and construction projects will still be ongoing.**

Coaches and Coxswain's Meeting:

Saturday :

There are 2 coaches/coxswains meetings on Saturday. You should attend the appropriate one. The one for master coxswains and scullers is at 7:30am.

The high school coaches and coxswains meeting is scheduled for **11:30AM**.

All boats must maintain the same lineup during the day of racing.

Sunday: Coaches/ coxswain meeting is at 7:30am.

Hints for coxswains at the Pittsford Regatta. (this mostly applies to high school races).

1. When you launch, know your bow number. From the start line facing the finish, **odd numbers race right hand lane (north, or Lane 1), even numbers in the left hand lane (south, or Lane 2).**
2. The start line for the high school match races is a culvert about 100 meters east of the Mitchell Rd. bridge. The culvert should have a yellow rock on top of it.
3. Don't stray too far from the start. The regatta usually runs on time, and if it running late they may be trying to make up time. The judges are there to help you, so you can ask how the schedule is going.
4. Winds are usually westerly. At the start, this means the wind comes from the port side. (about 10:30, if 12 o'clock is straight ahead) When you line up for the start, stay more to the left so that if the wind pushes you to the right, you have some room. This does not mean you can crowd the other crew if you are in Lane 1.
5. On the way down to the start, look at the stone wall that is on the north side of the canal just east of the Rt. 31 (green) bridge. If you are racing in lane 1, and you hug the shore when racing, you will hit this wall. That is not recommended, as the stone may scratch your boat.
6. When racing, and you pass under the Rt. 31 bridge, the shore on the right side bends away from the race course. Many coxswains make the mistake of following the shore after this bridge. You should be able to see the finish line buoys, head straight for them and do not follow the shore.

Launching:

All crews should anticipate launching 30-45 minutes prior to their published race time. Listen for bow numbers to be called by the dock master or his assistants. Plan to come down the ramp such that your bow is pointed west, away from the race course (to the right as you face the water). Tie in on the water, not at the dock. We will make every attempt to maintain the schedule. Please be aware that this means some boats cannot be re-rigged between rows. If you intend to hot seat any boats, please be advised that the race schedule will take precedence. You must advise the dock master in advance of any hot seating that might affect the launching sequence.

All boats must have:

Bow balls, Bow Numbers in the bow clip, heel straps tied down to within 3" in accordance with USRA rules. Boats with a large radius on the bow (Alden type shells) do not need a bow ball. Flotation compartments must be tight.

Traffic Pattern:

The traffic pattern is counterclockwise. From the launch, proceed westbound a short distance to the turn-around buoy, then proceed to the start staying to the right. The channel to the start will be marked with red buoys, keep the shell between the red buoys and the shore. Hazards will be marked with green or orange buoys. It is each crew's responsibility to not interfere with boats on the race course and to proceed to the start without delay or delaying other crew's progress to the start. Crews heading to the start must stop and be completely off the race lane as a race approaches. As you proceed down the course, be aware of docks that jut out from shore.

Masters should look for the bow number that precedes them and be ready to start in bow number order.

High school crews, at the start, should be aware of your race time, your lane and stay in the area of the crew with whom you are to race. Line up in accordance with the marshal's instructions.

Lane 1 (odd bow numbers) right lane, same side of canal as the tow path

Lane 2 (even bow numbers) left lane, same side as the travel lane

Once underway on the course, the center of the lanes will be marked in yellow.

Once you pass the Finish line, and the JR raises the white flag, proceed back to the dock.

Coxswain's, please: watch and listen for instruction as to where to dock.

Coxswains who are in need of assistance, or have a rower needing assistance, or lodging a protest, should raise their hand.

Course:

(See maps at end of document)

The master's race course starts just east of the Mitchell Road Bridge (black metal bridge) and will run Head Race style to the finish in the Village. You may race up either lane when on the high school portion of the course.

The High School races will start just east of the Mitchell Road Bridge. These will be Sprint races in two lanes with the same finish in the village.

Protests:

Protests regarding safety issues, being at the start on time, etc. shall be made to the Judge at the Start. Leaving the start area (starting the race) signifies acceptance of fairness of the start or that you have lodged your protest.

If a crew feels it is being unfairly delayed in rowing up to the start, communicate with one of the safety marshal on the way to the start and protest to the JR at the Start.

Protests regarding safety issues, failure to yield right of way, and passing, unsportsmanlike conduct must be made to the marshal at the Finish, on the water. Leaving the finish area signifies acceptance of the fairness of the race or that you have lodged your protest.

Penalties:

Penalties will be assessed by the USRA Officials at their discretion on site.

The penalty for late at the start line (2 minutes prior to start time) is a warning (equivalent to one false start), or, if beyond the time of the race start, exclusion.

Violation of the traffic pattern to the start = 1 false start assessment

2 false starts = exclusion

Unsportsmanlike behavior: Disqualification from the regatta.

Broken equipment and cannot repair on the water and be on time for start - exclusion

This does not constitute a comprehensive list of potential infractions and penalties. Final judgments will be made by the USRA Judge/Referees on site.

Medals:

First place medals only, will be awarded if there are two boats registered in an event. First and Second Place Medals will be awarded in all races with three or more registrants. Medals will be available at the registration area when the final race is declared official.

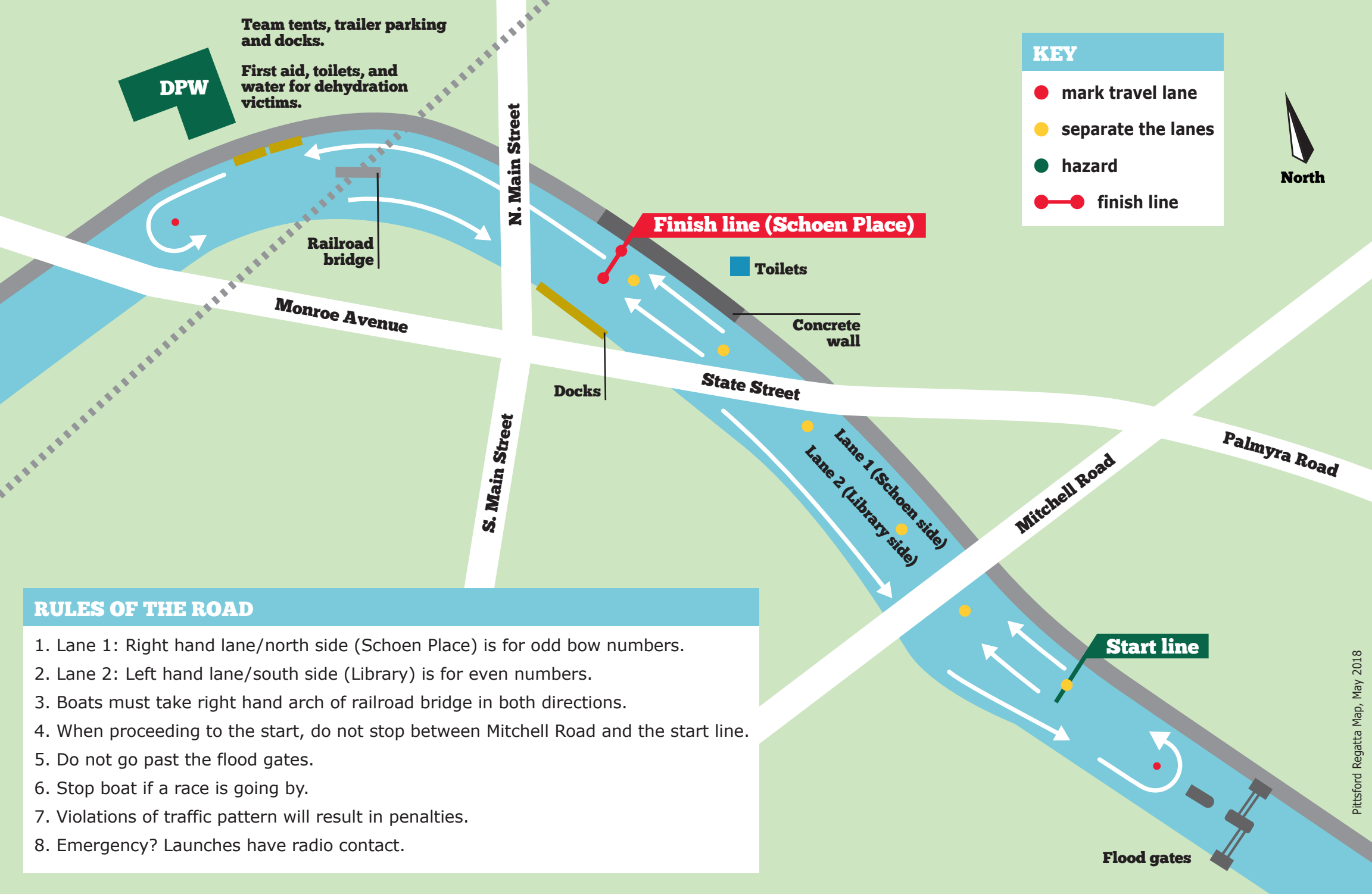

Team tents, trailer parking and docks.

First aid, toilets, and water for dehydration victims.

DPW

Railroad bridge

Monroe Avenue

N. Main Street

Finish line (Schoen Place)

Toilets

Concrete wall

Docks

State Street

Lane 1 (Schoen side)
Lane 2 (Library side)

Mitchell Road

Palmyra Road

Start line

Flood gates

KEY

- mark travel lane
- separate the lanes
- hazard
- finish line



RULES OF THE ROAD

1. Lane 1: Right hand lane/north side (Schoen Place) is for odd bow numbers.
2. Lane 2: Left hand lane/south side (Library) is for even numbers.
3. Boats must take right hand arch of railroad bridge in both directions.
4. When proceeding to the start, do not stop between Mitchell Road and the start line.
5. Do not go past the flood gates.
6. Stop boat if a race is going by.
7. Violations of traffic pattern will result in penalties.
8. Emergency? Launches have radio contact.

Coxswain Map

(Contains landmarks & visual cues on the course)

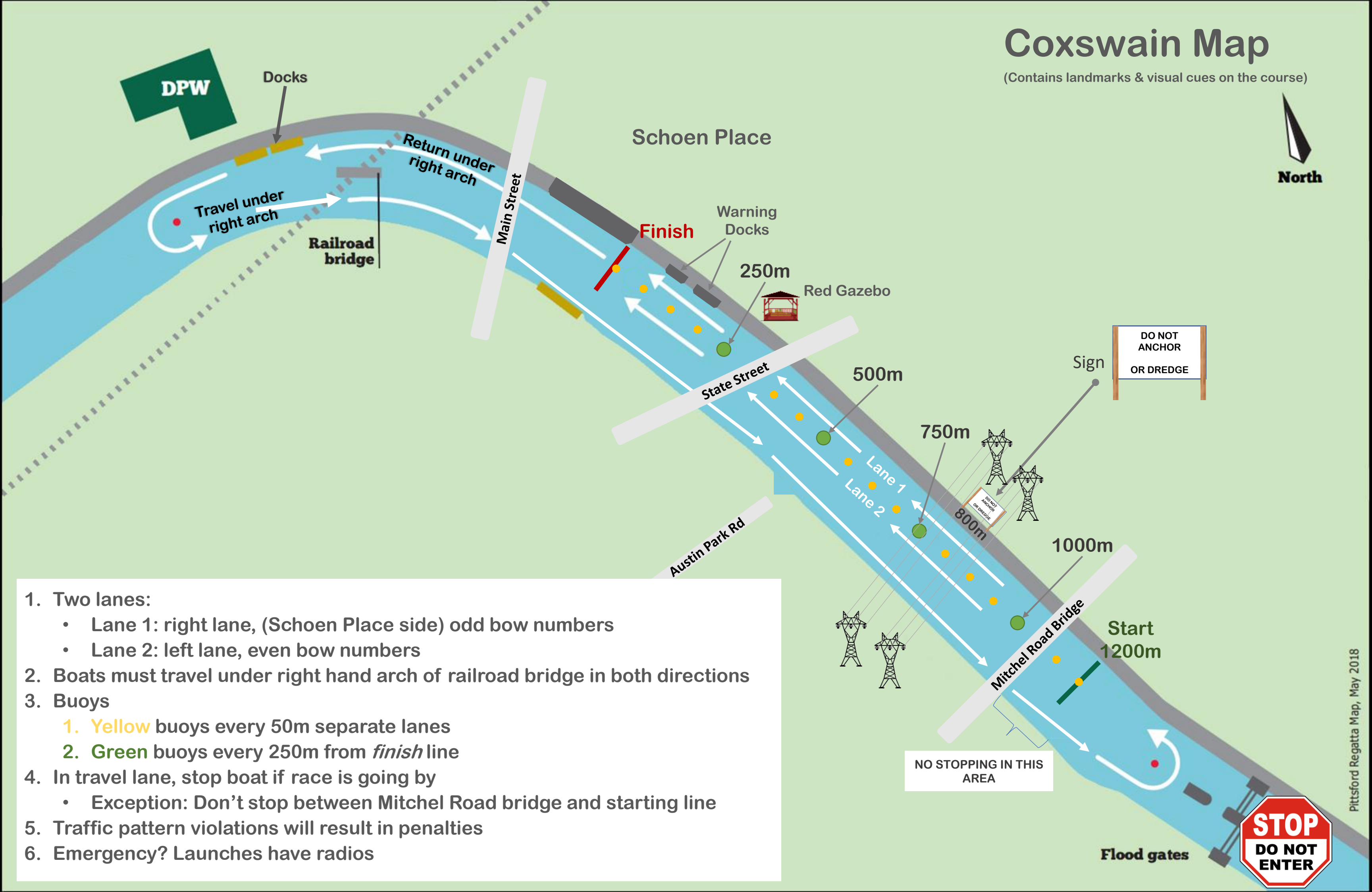

1. Two lanes:
 - Lane 1: right lane, (Schoen Place side) odd bow numbers
 - Lane 2: left lane, even bow numbers
2. Boats must travel under right hand arch of railroad bridge in both directions
3. Buoys
 1. Yellow buoys every 50m separate lanes
 2. Green buoys every 250m from *finish* line
4. In travel lane, stop boat if race is going by
 - Exception: Don't stop between Mitchel Road bridge and starting line
5. Traffic pattern violations will result in penalties
6. Emergency? Launches have radios